

## Pedestal Stand Assembly(XL-2)

- 1) Lay out all the parts on the floor. Place legs (A&B) with the wheels, parallel to each other as shown
- 2) Attach the upright (C) to the legs (A&B) using 4 bolts (505D031) and 4 washers (56806)
- 3) Attach cross bar (D) to the legs using 4 bolts (56426) and 4 washers (56806) to the front of the legs
- 4) Place the adjustment upright (E) inside the stationary upright (C). The adjustment upright is held in place by the non-locking spring plunger and secured by the lever clamp.
- 5) Place the support plate tube (F) inside the tube on the adjustment upright and secure the lever clamp
- 6) Add the pedestal stand bracket (505D028) to (F) using 4 screws (P001952 ) and 4 washers (P004715 )
- 7) Screw 4 washers (16614) and 4 Hex Nuts (56507) to secure the bracket to (F)
- 8) Attach XL-2 machine frame (505D173) to top of bracket (505D028) with 4 washers (P004715) and 4 screws (P002201).
- 9) Mount the pedestal stand bracket (505D028) with attached XL-2 to support plate (F).

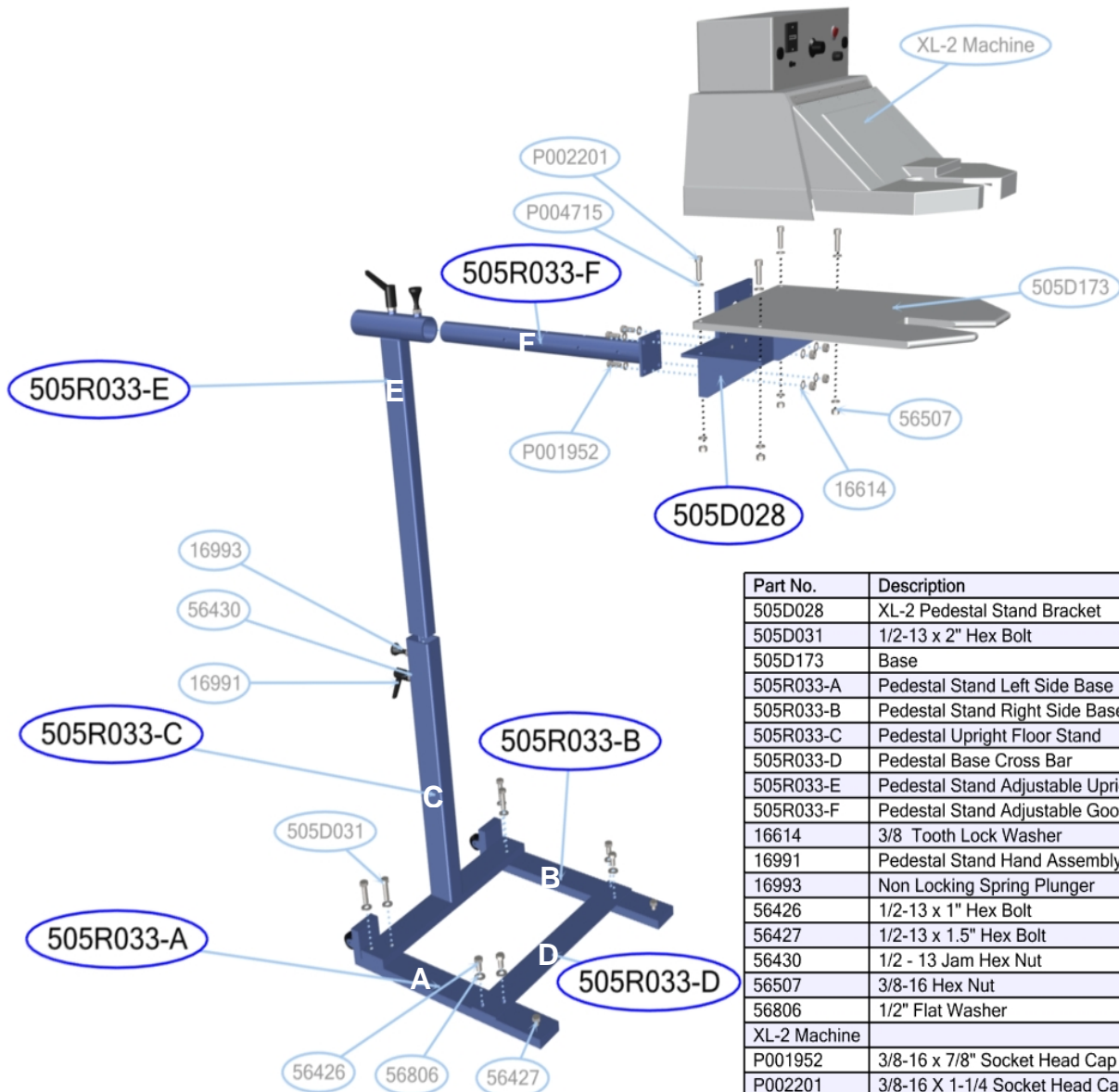

Part No.	Description	Qty
505D028	XL-2 Pedestal Stand Bracket	1
505D031	1/2-13 x 2" Hex Bolt	4
505D173	Base	1
505R033-A	Pedestal Stand Left Side Base	1
505R033-B	Pedestal Stand Right Side Base	1
505R033-C	Pedestal Upright Floor Stand	1
505R033-D	Pedestal Base Cross Bar	1
505R033-E	Pedestal Stand Adjustable Upright	1
505R033-F	Pedestal Stand Adjustable Gooseneck	1
16614	3/8 Tooth Lock Washer	4
16991	Pedestal Stand Hand Assembly	2
16993	Non Locking Spring Plunger	2
56426	1/2-13 x 1" Hex Bolt	4
56427	1/2-13 x 1.5" Hex Bolt	2
56430	1/2 - 13 Jam Hex Nut	4
56507	3/8-16 Hex Nut	8
56806	1/2" Flat Washer	8
XL-2 Machine		1
P001952	3/8-16 x 7/8" Socket Head Cap Screw	4
P002201	3/8-16 X 1-1/4 Socket Head Cap Screw	4
P004715	3/8 Split Lock Washer	12

Rev 08.14.2014